

hanström

5-in-1 Boiling Water Tap

Installation Manual



Safety Instructions - Please Read

We are delighted that you have chosen our multifunctional water dispenser and intelligent tap. This unique water dispenser appliance will save you time and effort when requiring boiling water, chilled water, filtered water for making tea and coffee and we are sure you will discover many new uses each day. Please read and follow our step by step guide to the installation, operation and care for the appliance and you will soon be making that first cup of coffee or tea from your new appliance.

What you need to know...

Please Read Carefully

For your safety and satisfaction please read all the instructions, cautions and warnings before installing or using this multifunctional water dispenser appliance.

Important Notice

This product can cause harm if installed incorrectly and should only be installed by a competent person, if you feel for any reason unsure about the installation, please contact a qualified plumber or electrician to install the appliance.

Wire Connections

Make sure all electrical wiring and connections conform to local standards. Make sure all water connections conform to local standards.

Electric Outlet

A standard 220/240v grounded 13 amp switched electrical outlet is required under the sink for the multifunctional water dispenser appliance, and must supply electrical power continuously to the appliance. The power outlet must be connected to the 13amp fused plug supplied.

Open Vented System

The multifunctional water dispenser appliance is an open vented system appliance. When not being operated the pressure is 1.0bar. The operating pressure is 1.5 bar to 5 bar.

Water Filter

The water filter must be connected to the multifunctional water dispenser appliance. Failure to change filter every 6 months may invalidate your warranty.

Equipment Required

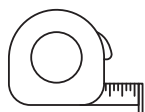

Tape Measure

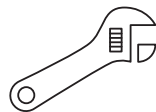

Adjustable Wrench

Safety Instructions - Continued

The alert symbols displayed on the below point to important safety information to make you aware of potential hazards that can cause serious injury or death. Please pay special attention to the information following these warning alerts. Failure to comply with these instructions could result in property damage, serious injury or death. Please read this chapter carefully for your own safety and the safety of those around you.



DANGER



WARNING

Please read the safety information in this instruction, installation guide and on the product in order to install and use the product accordingly, so as to avoid any injury. The safety information will tell you what the potential danger is, how to avoid it, and identify what will happen if you do not operate following the instruction.

Electric Shock

Using an ungrounded connection or improper connection of the power supply to the product can result in a serious injury or death from electrical shock.

- Do not remove the earthing terminal.
- Do not reconstruct the plug.
- Do not disassemble main box and any part for the power.

Important

The instructions are only intended as a guide, if there is any doubt then please contact a certified plumber or electrician or point of purchase and avoid using the product until it has been checked.

Protection

To protect against electrical shock, do not place cord, plugs or unit near or in water or other liquids and do not operate the multifunctional water dispenser appliance controls or power socket with wet hands.

Power Rating

Check the power rating of your multifunctional water dispenser appliance is suitable for the power rating of the electrical circuit it is being installed on.

Faulty

Do not operate or install the multifunctional water dispenser appliance if it appears to have any missing parts, be damaged/faulty eg damaged cord, plug.

Intended Use

Do not use outdoors or in a damp area. Do not use the multifunctional water dispenser appliance for anything other than the intended domestic use.

Repairs

Do not attempt to open, modify or service this multifunctional water dispenser appliance. Repairs should be carried out by authorized service personnel. Opening the unit may void the guarantee.

Unplugging

Turn off all controls before unplugging. Do not unplug by pulling the cable. To unplug, grasp the plug, not the cable.

Property Damage

To avoid the risk of flooding, regularly inspect the unit for any signs of leakage.

Safety Instructions - Continued

IMPORTANT

This multifunctional water dispenser appliance is not intended for use by persons (including children) with reduced physical, sensory or mental capabilities, or lack of experience and knowledge, unless they have been given supervision or instruction concerning use of the appliance by a person responsible for their safety. Children should be supervised to ensure that they do not play with the multifunctional water dispenser appliance or instant hot water tap, a child safety lock button is used to control the flow of the near boiling water for additional safety.

Components Included

The multifunctional water dispenser appliance is supplied with the following: The inlet and outlet of boiling water are connected to the silicone tube with a quick-insert connector. The inlet and outlet of cold water are directly connected by PE tube insertion.

! WARNING

Electrical Requirements

A 220/240-volt, 50 Hz, AC -only 13 amp fused, grounded electrical power supply is required. It is recommended that a separate circuit serving only electronic instant hot water appliance be provided or use an outlet that can be turned on/off by a switch.

This multifunctional water dispenser appliance is equipped with a power supply cord with a power plug. To minimise possible shock hazard, the cord must be plugged into AC ground-type outlet, grounded in accordance with all national and local codes and ordinances. If a socket outlet is not available, it is the responsibility and obligation of the customer to have a properly grounded outlet installed by a qualified electrician.

! WARNING

Water Supply Requirements

If local codes permit, the instant hot water tap feed line should be connected to the hot and cold water supply line using isolation valves or another means for providing the hot and cold water to the tap. **IMPORTANT:** If local codes do not permit the use of isolation valves, special feed valves can be obtained from your local plumbing supply distributor has been checked.

! WARNING

Environment Requirement

Don't install the multifunctional water dispenser appliance outdoors or in location that may fall below 0°C, otherwise the pipes and the tap will be frozen and there will be serious safety trouble, possible bodily injury, accidents and damage caused.

It's forbidden to wash the water dispenser appliance with water directly. The installation environment should be ventilated, with protection from the direct sunshine. When installing the water dispenser appliance, provide approximately 10cm to 15cm (4-5.2") of air space on the sides of the unit for air circulation and approximately 2.5cm(1") from the mounting wall. The environment humidity should be in the range of 10% to 60%. Be sure there is no dew.

! WARNING

IMPORTANT

Install the Tap in accordance with the fitting Instructions provided with the Tap. Observe all local governing codes and ordinances.

Safety Instructions - Continued

Location

The multifunctional water dispenser appliance must be mounted vertically and level. Before you begin, select a suitable location ideally directly under the Intelligent tap or close to it to ensure the connection pipes will connect from the intelligent water tap to the multifunctional water dispenser unit. Ensure that the multifunctional water dispenser appliance is placed so that you will be able to view and reach the touch control on the front face for adjustments.

Not Under Pressure

The water dispenser appliance is not under pressure, consequently, there is a slight delay in water flow after the hot water button has been turned on. This is normal and indicates that the water dispenser appliance is functioning properly.

Recommendation

It is recommended that you have access to a separate power circuit serving only your electronic instant hot water appliance. See previous pages for more information on "ELECTRICAL REQUIREMENTS".

! WARNING

Position The Water Dispenser Appliance

Ensure the water dispenser appliance is NOT connected to the electric power during installation.

Place the water dispenser appliance in position and check to ensure that the intelligent water tap connection pipes and the power cord will reach without being stretched.

The water dispenser appliance must be positioned so the tubes from and to the water tap do not twist or kink.

Connect Tap

Connect the water dispenser appliance with the tap according to the manual. Fitting a pressure reducing valve to the cold mains inlet if the mains pressure is above 5bar. Tighten with a wrench and move to check if the complete installation leaks.

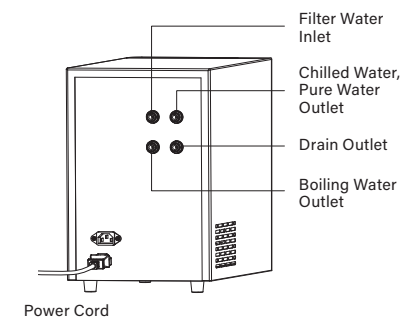
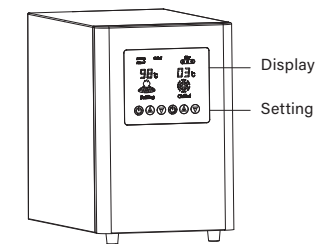

Safety Instructions - Continued

Connect the Plug

Connect the plug to the power socket and turn on the power socket at the switch. The multifunctional water dispenser appliance display panel will light up with the on/off.

Electronic Display Panel



ON/OFF to control the power

Temperature setting: press to + or - select required temperature. Temperature setting range : 65-99°C.

Your filter alert will be blinking when your filter requires changing, or the filter life indicator turn to red colour on digital tap display panel. Please visit our website for filter purchase or scan the QR code on the filter.

If the multifunctional water dispenser appliance is empty of water and is turned ON then this will be automatically sensed, the display will show "E3". The tank needs to fill with water through the boiling water control handle on the tap.

When the display shows "E4", please unplug the boiler. If the problem still exists, please contact service centre to have the tank checked and repaired.

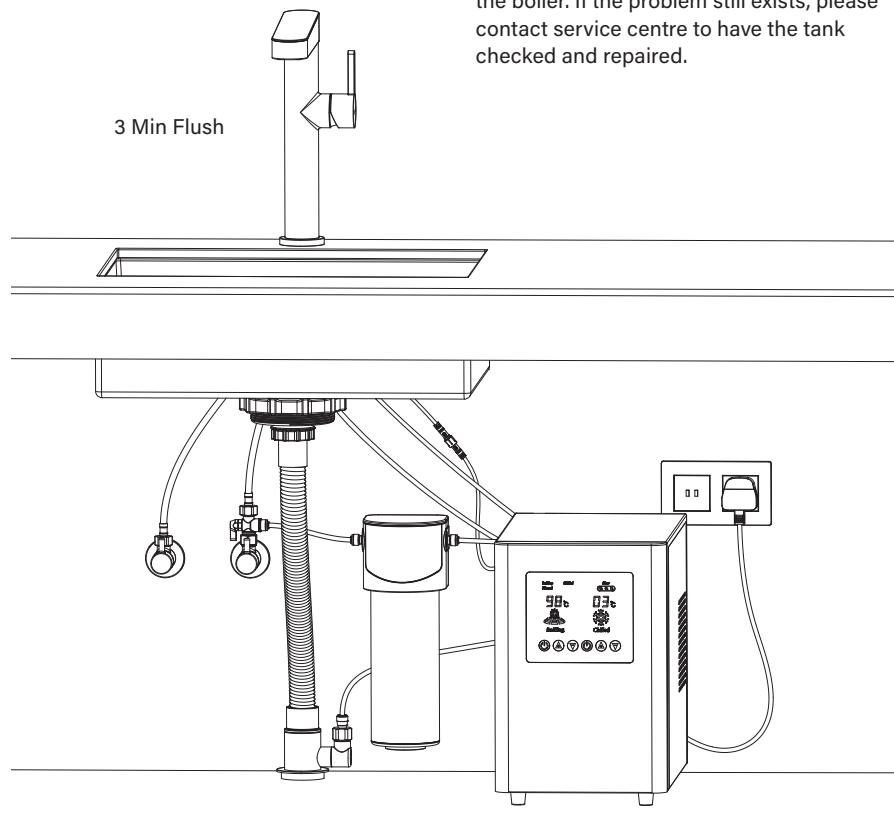

Safety Instructions - Continued

Operation Instruction

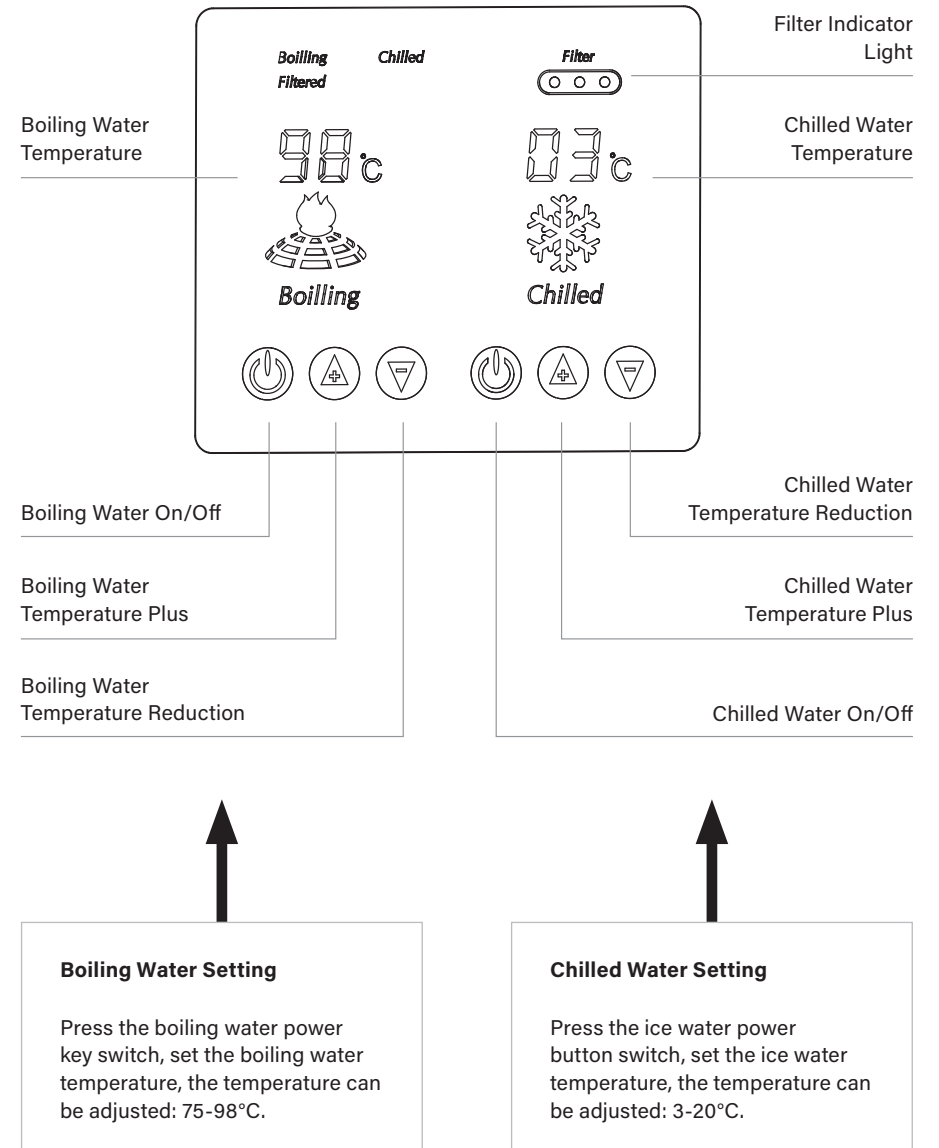

Installation Illustration

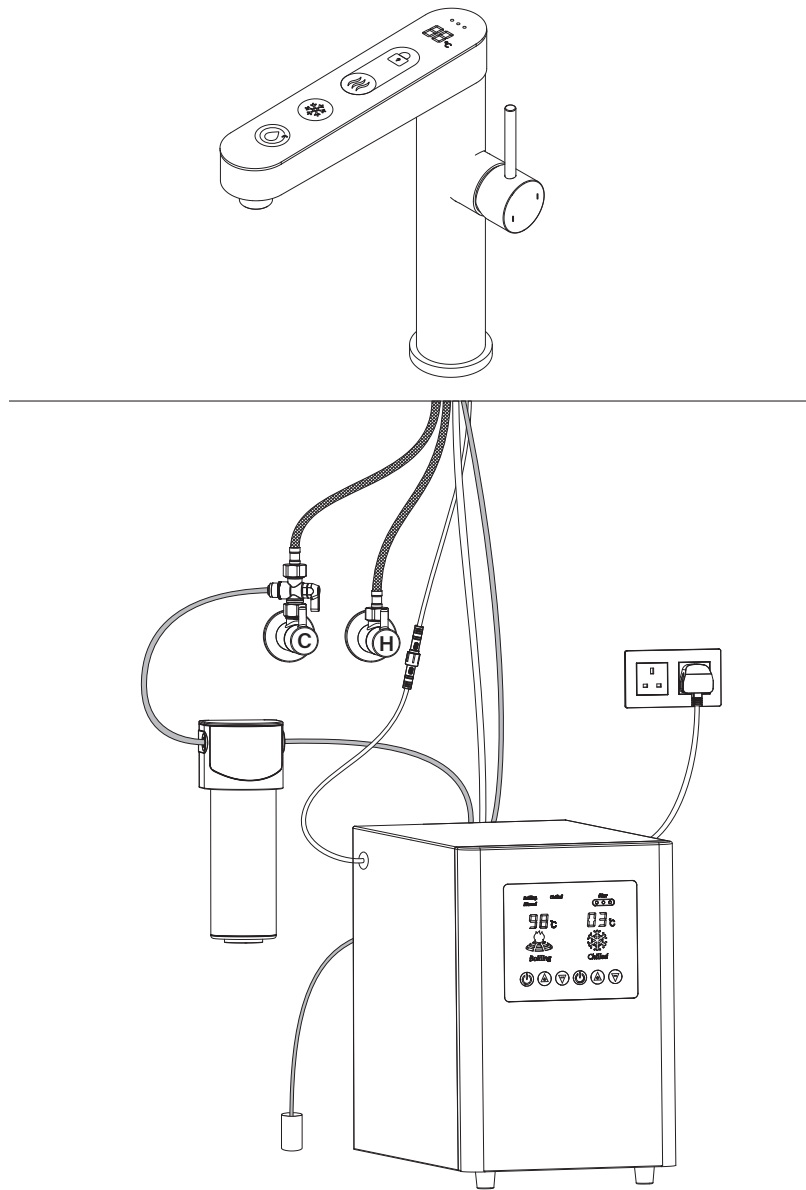

Component List

Not to scale

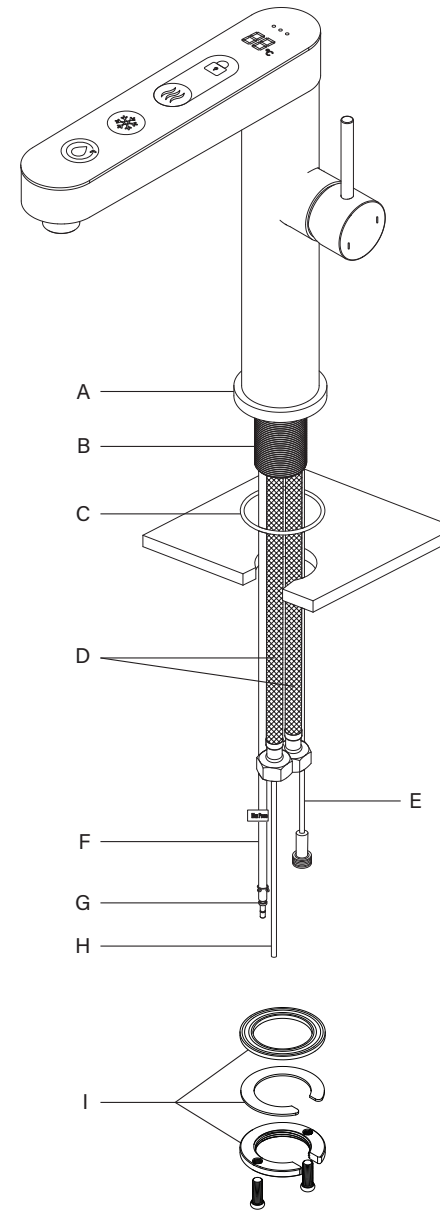

A.	Base
B.	Threaded Tube
C.	Gasket
D.	Flexible Tails (Red & Blue)
E.	Signal Line Connector
F.	Silicon Tube (Installed)
G.	Connector
H.	PE Tube (Installed)
I.	Locking Assembly
J.	3 Way Change-Over Valve
K.	PE Tube

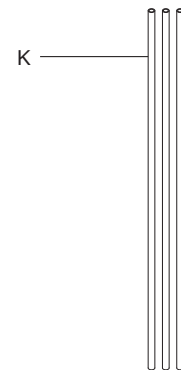
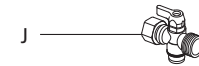

Installation

Installation Procedure

1. Insert the gasket (A) and gasket (B) into the bottom of the faucet and place the faucet in the mounting position.

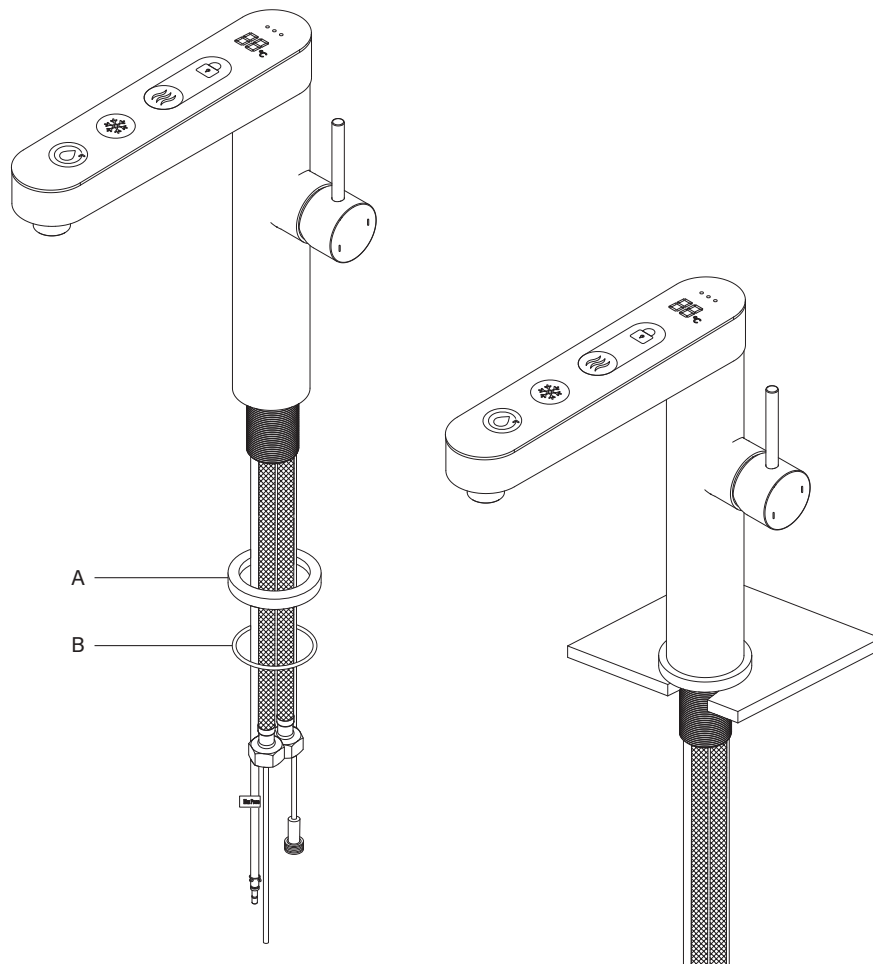

Installation - Continued

2. Put the Locking Assembly (C), into the fixing tube and lock them tightly.

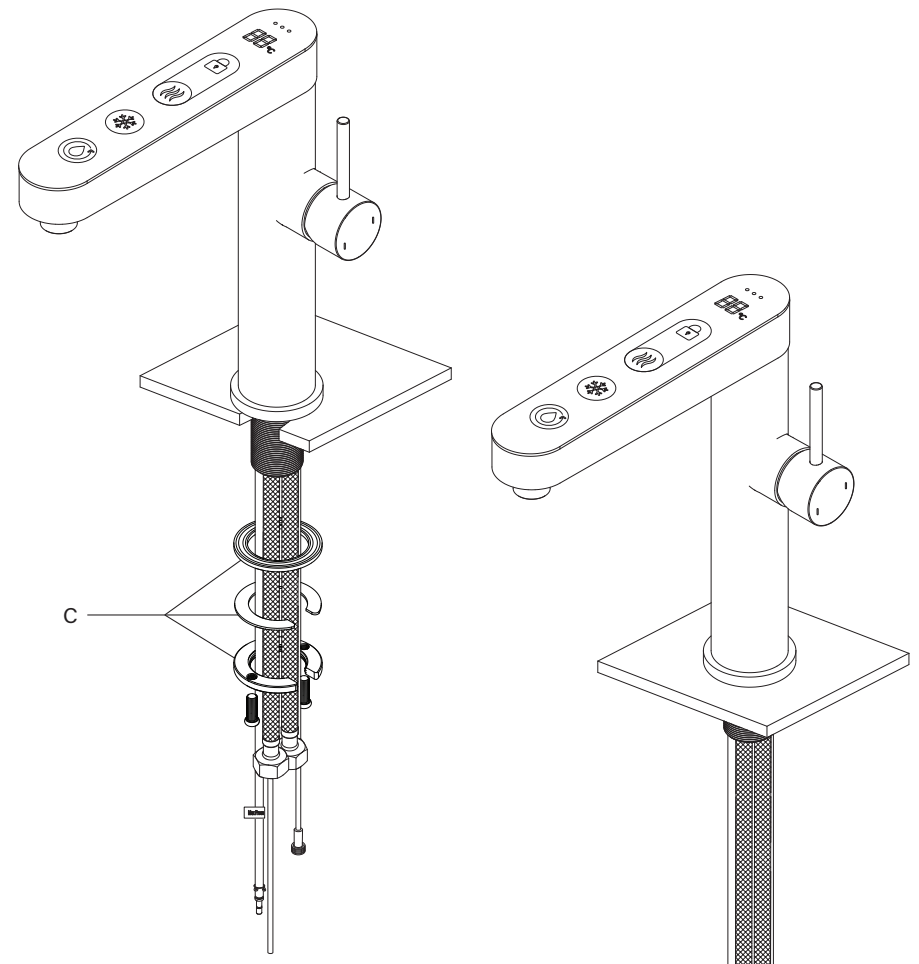

Installation - Continued

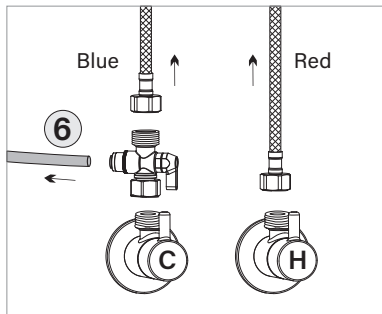
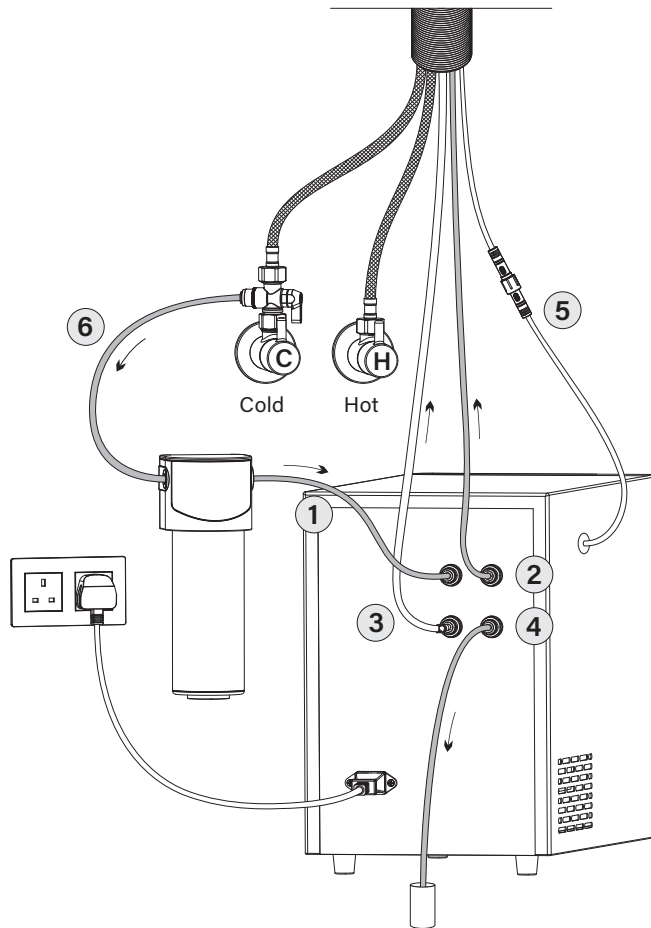

3. Connect the red tail on to the angle valve from hot water supply side.

The blue braided tube is connected to the three-way transfer valve and installed on the cold water angle valve.

Installation - Continued

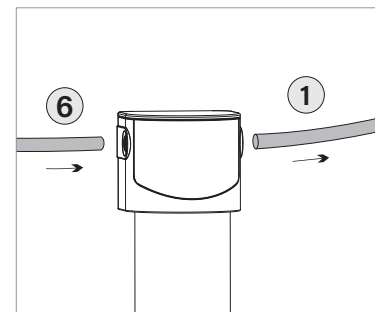
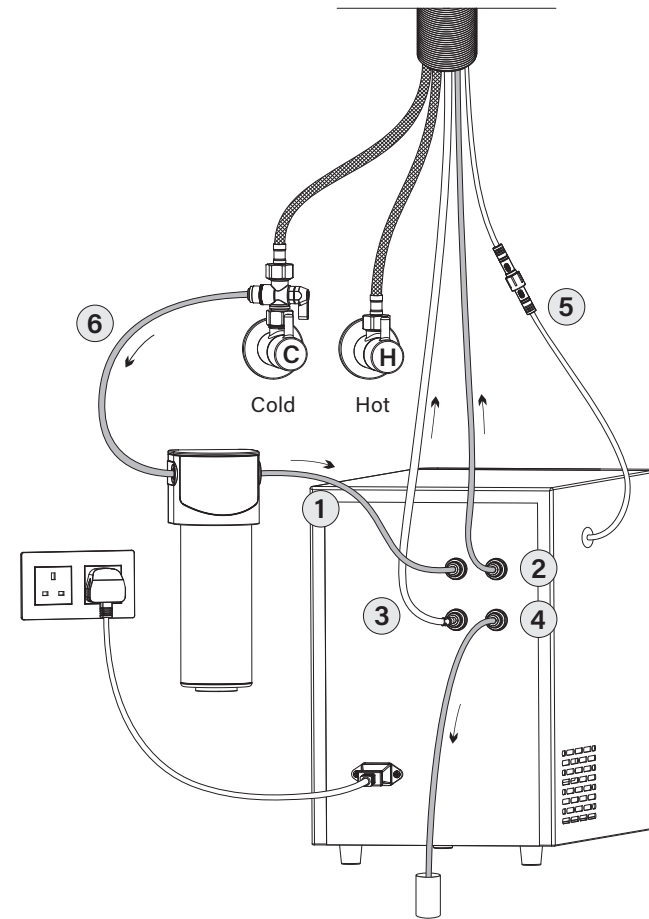

4. No. 6 PE water pipe is connected to three-way transfer valve and filter.

No. 1 PE water pipe is connected to filter.

Installation - Continued

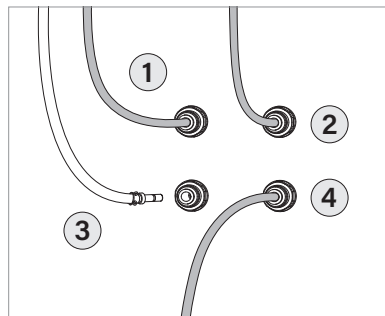
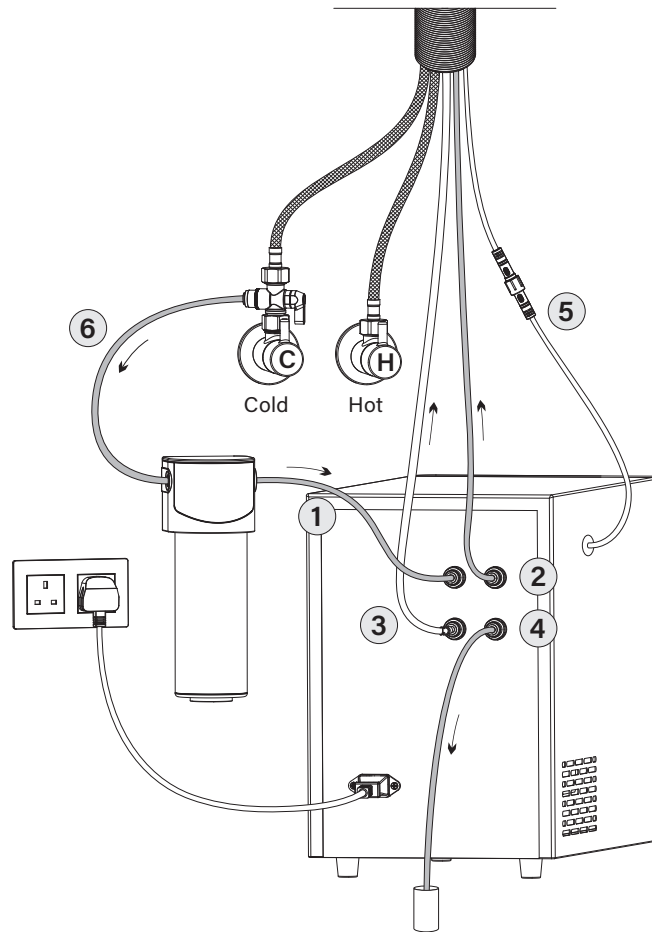

5. Install No. 1, No. 2, No. 4 pipe and No. 3 silicon tube respectively on the corresponding interface of the heating tank, as shown in the figure.

Connect the other end of PE pipe No. 4 to the drainpipe.

Installation - Continued

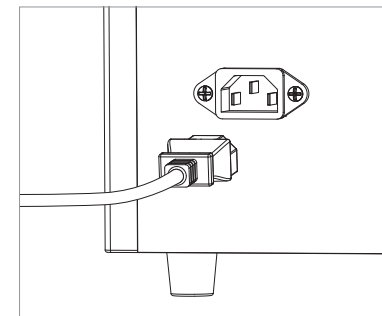
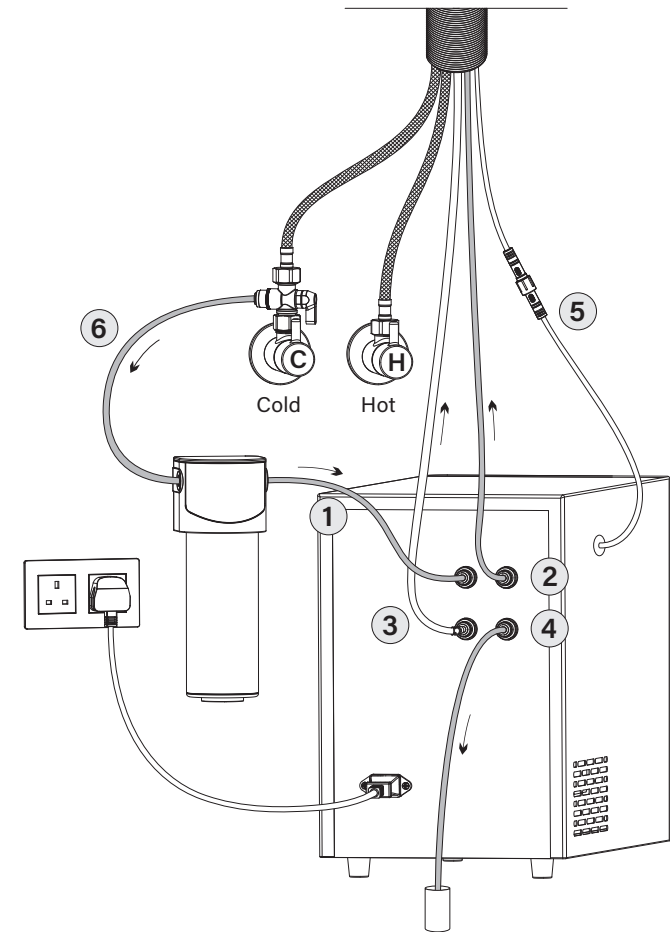

6. No. 5 signal line connector connecting faucet to heating tank.

Plug it in, press the power button for boiling and chilled water respectively, and set the temperature.

Maintenance & Care

5-in-1 Combination Instruction

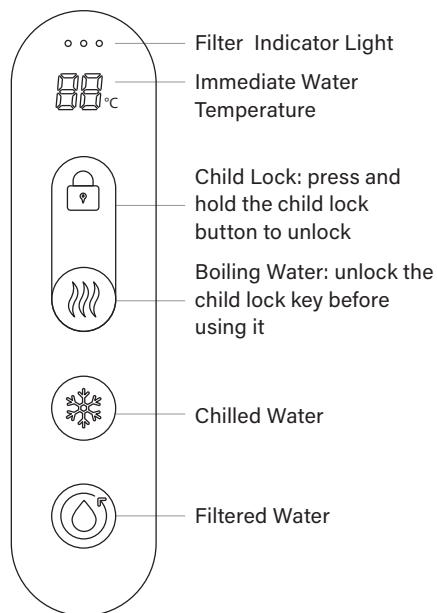

Maintenance & Power Saving

If the multifunctional water dispenser appliance is not being used for long periods of time ie:

- over 7 days, to save power we recommend you switch off using
- Press the "ON/OFF" switch to turn off.

Seasonal Shutdown

The multifunctional water dispenser & tap must not be exposed to freezing temperatures. If there is a possibility of this the system must be drained of water. Shut-off the mains supply and unplug the unit from the electricity mains and allow the tank to cool for at least 1 hour.

Disconnect the inlet supply to the tank and remove the silicone hose outlet pipe, lift the unit to the sink, there are 2 drain screw under the bottom of water dispenser unit, loosen the drain screw and drain all the water from the tank. When reinstalling follow the original installation instructions.

Filter Change

To maintain warranty, filters must be changed every 3-6 months or sooner if 2,000 litres of water have been used. This is very simple to do and the filters can be purchased directly from us.

Your machine has been fitted with a filter alert, once this is flashing please scan your bar code for a replacement to be purchased.

Matching Products

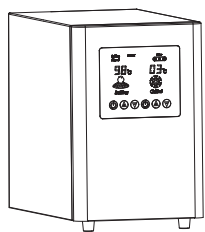

Boiling Water and Chilled Water Machine Unit

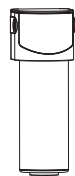

Filter

Trouble Shooting

PROBLEM	POSSIBLE CAUSE	WHAT TO DO
Water and steam is spitting from the intelligent tap spout.	Unit is boiling	Make sure drain pipe placed correctly, it's position should be lower than appliance drain outlet position.
	Pressure is lower than 1.5 bar or higher than 5 bar.	Check the pipe pressure. Check if aerator is blocked and remove the dirt in the aerator.
Water is not hot.	The multifunctional water dispenser is unplugged.	Make sure the electronic instant hot water appliance is plugged in and connected to a grounded electric outlet.
		Make sure that the circuit breaker and fuse are working correctly.
Water is not cold.	Water temperature setting is set to high temperature.	Re-set the temperature to the lower temperature.
Slow flow from the spout.	Water filter may be clogged from impurities in the inlet mains water.	The water filter must be changed every 6 months or this will void guarantee.
No water flowing.	Water valves have been turned off.	Turn on all the water valves.
	Inlet pipes have been twisted or blocked.	Ensure the pipes are not twisted or kinked or restrict flow. Remove and clean the aerator. Remove the electronic instant hot water appliance as per the de-scaling instructions and flush through all pipes to ensure water flow.
E3 fault code.	The E3 code indicates water shortage protection. When the water level in the inner tank is below the minimum required level 'E3' will appear.	Unlock child safety lock, press boiling water button, let water flush into boiler tank until the water flow out from tap spout.
	If the above does not work and unit continues to show 'E3' it could be a float switch sensor fault.	Contact the retailer.
E4 fault code.	Hot water sensor fault.	Power off the unit and unplug from the power source. Then try reinstalling. If this does not solve the issue, contact the retailer.
Circuit tripping in the house.	The electric meter is overloaded, the installation of your instant hot water appliance in addition to the rest of your appliances has exceeded the limit of the RCD protection limit.	Upgrade the RCD protection limit or move the instant hot water appliance on to a different circuit.

Fault Code Summary & Basic Parameter

Chilled Water & Sparkling Water Sensor Fault

FAULT CODE DISPLAY	MEANING	NOTE
Screen Display		
E3	Water shortage protection	
E4	Hot water sensor fault	
E5	Chilled water sensor fault	
E6	CO2 High pressure protection	
E7	Communication failure between machine display screen and main control board.	
Tap Display		
E0	Communication failure between tap and main control board.	
E1	Pure water sensor fault	

Basic Parameter of Multifunctional Water Dispenser Appliance

Heating tank power supply	220Vac, 50Hz, 1.8KW
Heating tank standby power consumption	3W
Heating tank water storage capacity	2.4L
Chiller power supply	220Vac, 50Hz, 0.15KW
Chiller standby power consumption	3W
Chiller water storage capacity	2.4L
Pressure valve of chilled water tank	0.3Mpa
The water inlet temperature heats from 25°C-98°C	Around 10-12min (depending on ambient temp)
Water inlet temperature 25°C cooling to 5°C	Around 30-35min (depending on ambient temp)

After machine is installed properly with taps, plug in the machine, the water is connected with heating tank. Click the touch screen to unlock the childlock, click the boiling water button and flashing for 1.5 minutes until the water comes out of the faucet, and set the boiling water temperature. Can continue to let the outlet water flush for 3min. After machine is installed properly with taps, the water is connected by chiller tank. Click the chilled water button on the touch screen and flash for 2 minutes until water flows out of the faucet, it needs to connect the water first, and then set the machine temperature. Can continue to let the outlet water flush for 3min. If the multifunction water dispenser (heating tank, chiller water tank, and water channel), not used for a long time, it is recommended that users release water once every 72 hours to let the water flow, to avoid long-term water deposition and the growth of bacteria. Keep good drinking water effect.

Installation Check List

- Check the contents of the boxes to ensure that everything is present.
- Visually inspect the items to ensure that all parts and pieces are in good condition.
- Install the tap, making sure the tails are properly installed according to the instructions.
- Check that the tap is securely fastened to the worktop.
- Install the filter housing bracket and position the boiler with the piping connected.
- Once cut, make sure the filter poly pipe is clear of debris. If any swarf is visible, it should be removed prior to installation.
- Push the filter capsule into the housing bracket and turn clockwise. Connect the tails to the boiler, including the nipple for the silicon hose.
- Examine the instructions to ensure that the cold inlet is connected to the tap, followed by the connection to the filter and then the boiler back to the tap. That is the order.

The inlet to the appliance must be filtered.

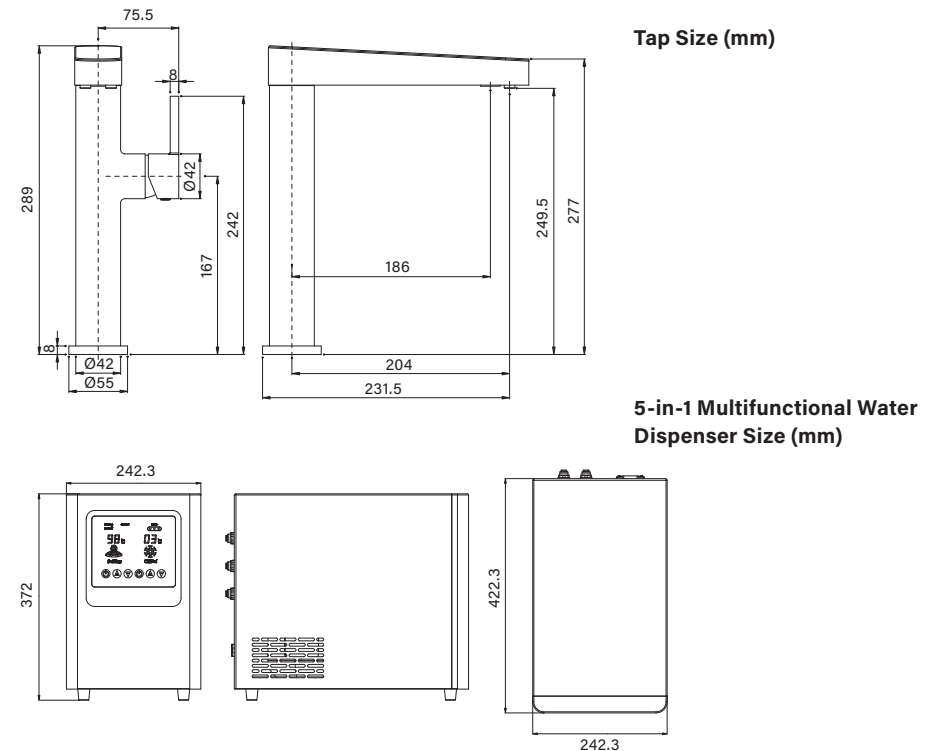

hanström

Tap into the future.